

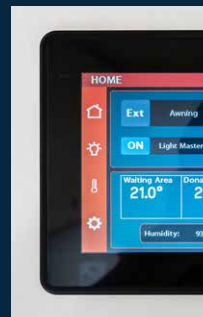

WINNEBAGO
SPECIALTY VEHICLES

COMMERCIAL SHELLS

A vehicle from Winnebago Industries® Specialty Vehicle Division offers convenience and flexibility with the same quality you'll only find from Winnebago. Built to our SuperStructure® construction standards, Winnebago Commercial Shells have steel backing in the walls and ceiling, Thermo-Panel® sidewalls, and interlocking joints for added durability. Our expert design teams and experienced craftsmen work with you to provide a tailored vehicle with flexible floorplan designs, chassis options to suit different budgets, and available pre-installed features. Whether you need a mobile space for sales and service, a classroom, or a clinic, Winnebago Commercial Shells can fit your needs.





425s

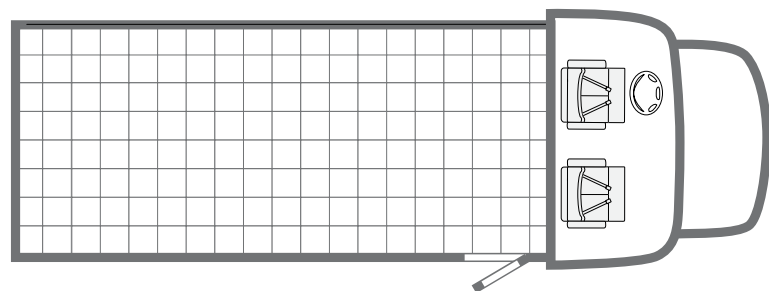

DÉCOR



Beige Cloth Seats



Gunmetal Ultraleather (Optional)

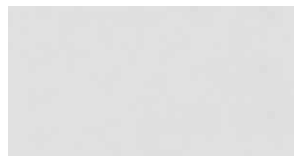

Polar White Exterior



Silkwood Wall Board



Wood - Driftwood II

Winnebago® reserves the right to change décor materials and specifications without notice or obligation.

425s Specifications

WEIGHTS & MEASURES

425s

| | |
|----------------------|--------|
| Length | 27' 4" |
| Exterior Height | 10' 4" |
| Exterior Width | 8' 4" |
| Interior Length | 18' 5" |
| Interior Height | 6' 10" |
| Interior Width | 8' |
| Fuel Capacity (gal.) | 55 |
| Wheelbase | 182" |
| GVWR (lbs.) | 14,500 |

Chassis

350-hp 7.3L V8 Triton® Engine, Torqshift™ 6-Speed Automatic Overdrive Transmission w/Tow/Haul, Hydro-Max Brakes w/4-Wheel

ABS Trailer Hitch 6,500-lb. Drawbar 500-lb. tongue weight w/7-pin Trailer Connector

Body

Thermo-Panel Insulated Sidewalls

Vertical Body Aluminum Extrusions 16" on Center

Steel Horizontal Attachment Points

Commercial Entry Door

Dual Coach Batteries

Powered Retractable Entry Step

Interior

Driver and Passenger Seats (Non-Swivel)

Overhead Cab Storage

1.125" Solid Plywood Flat Floor

Radio/Rearview Monitor System

OPTIONAL FEATURES*

Entrance Door Delete

2nd Rear Entry Door

Patio Awing - Electric

Rear Ladder

Generator - Commercial 7,000 Watt

Walls: Antimicrobial Fiberglass, Decorative Paneling, Luan

*Contact Winnebago Specialty Vehicles for further optional features (ex: windows, A/C, heater, etc.)



J33S

J33S No Slide

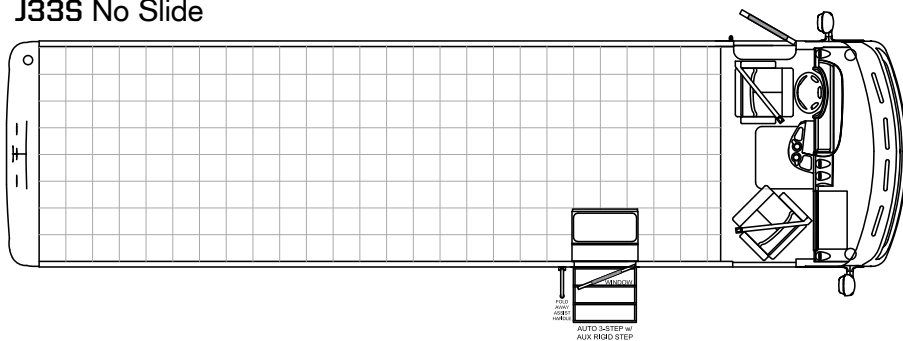

J33S One Slide

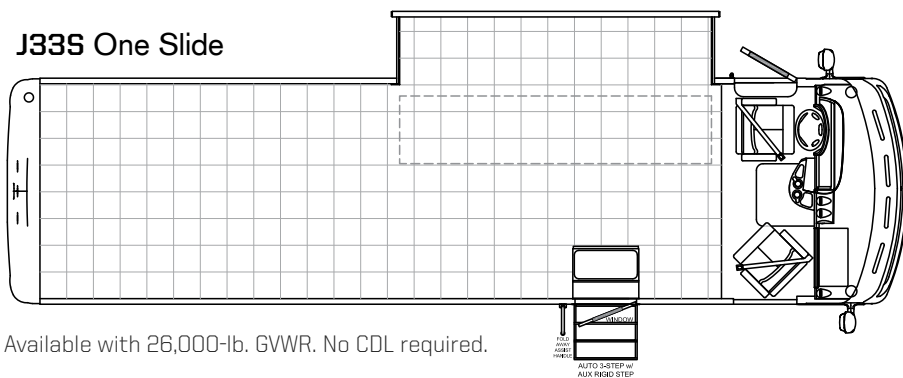

Available with 26,000-lb. GVWR. No CDL required.

DÉCOR



Steerhide Ultrafabric

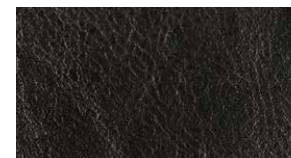

Black Onyx Ultrafabric (Optional)



Silkwood Wall Board



Beige Bisque Carpet



Wood - Sonoma



Wood - Driftwood II

Winnebago® reserves the right to change décor materials and specifications without notice or obligation.



J33S Specifications

| WEIGHTS & MEASURES | J33S Ford® | J33S Freightliner® |
|-------------------------------|------------|--------------------|
| Length | 33' 6.5" | 33' 6.5" |
| Exterior Height w/Roof A/C | 11' 10" | 11' 10" |
| Exterior Width | 8' 5.5" | 8' 5.5" |
| Interior Height | 7' | 7' |
| Interior Width | 8' 0.5" | 8' 0.5" |
| LP Capacity - optional (gal.) | 28 | 28 |
| Fuel Capacity (gal.) | 80 | 80 |
| Wheelbase | 208" | 208" |

Ford 22,000-lb. Gas Chassis

350-hp 7.3L V8 Triton® Engine, TorqShift™
6-speed Automatic Overdrive Transmission
w/Tow/Haul, Hydro-Max Brakes w/4-Wheel ABS

175-amp. Alternator

1.125" Solid Plywood Floor

7-pin Trailer Wiring

Trailer Hitch 5,000-lb. drawbar/500-lb.
maximum vertical tongue weight

Leveling System - HWH Automatic Controls
(front 9,000-lb./rear 12,000-lb.)

Seats - Ultrafabrics

Carpeted Storage Areas

Steel Front End Structure Designed for
Engine Removal

Valence Panels - Integrated Storage Doors

Front Overhead Storage Cabinet

Convenience Tray w/Cup Holders

Stylized Aluminum Wheels

Driver Cab Entry Door

Auxiliary Defroster Fans

Powered Front Shade

Map Lights

Power Mirrors w/Defrost

Passenger Seat Dash Workstation

Cruise Control

Fog Lamps

Radio/Rearview Monitor System

Freightliner 26,000-lb. Diesel Chassis

Cummins® ISB 6.7L 340 HP Engine @
2,600 RPM; 700 lb.-ft. @ 1,600 RPM

Allison® 2350 MH-Series 6-speed
Automatic Transmission w/Park Pawl

OPTIONAL FEATURES

Freightliner 26,000-lb. Air Brake/Air Suspension

Freightliner 27,500-lb. Air Brake/Air Suspension

Slideout Room

Left Side

Fiberglass Interior Walls

Exterior Ladder

7KW - 20KW Commercial Generators

Entrance Door Window

LP Tank and 35,000 BTU Furnace

Walls: Antimicrobial Fiberglass, Decorative
Paneling, Luan



J38S

J38S No Slide

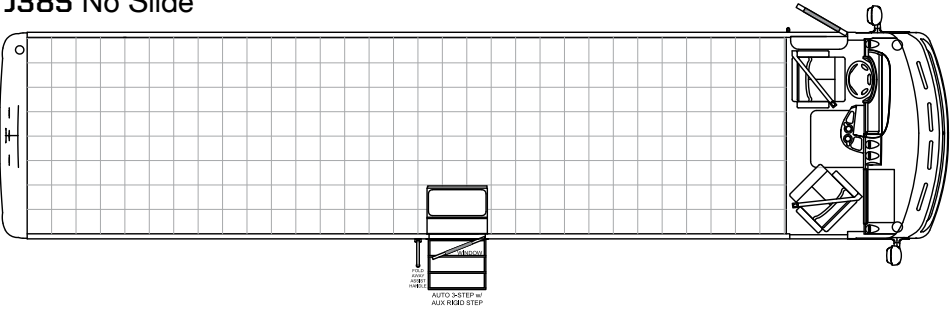

J38S Two Slides

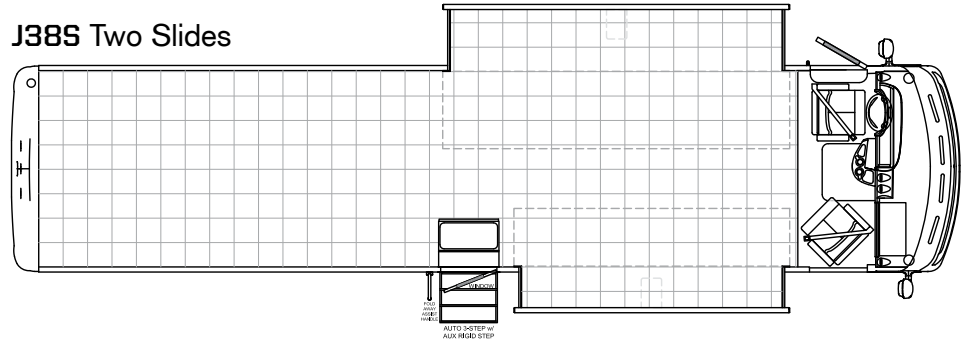

J38S One Slide

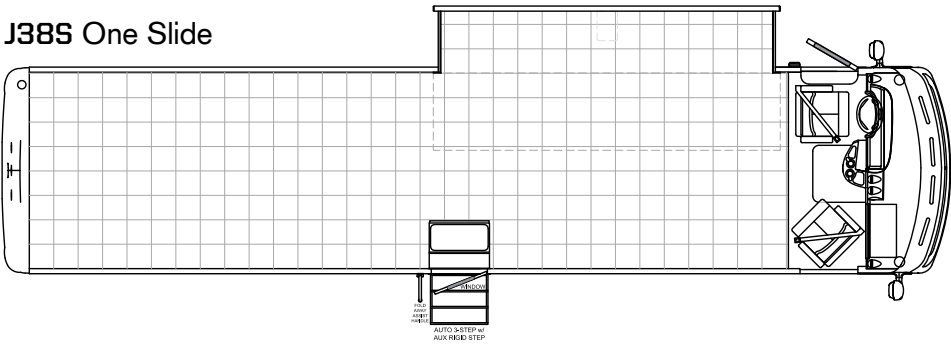

Available with 26,000-lb. GVWR. No CDL required.

DÉCOR



Steerhide Ultrafabric



Black Onyx Ultrafabric (Optional)



Silkwood Wall Board



Beige Bisque Carpet



Wood - Sonoma



Wood - Driftwood II

Winnebago® reserves the right to change décor materials and specifications without notice or obligation.



J38S Specifications

| WEIGHTS & MEASURES | J38S Ford® | J38S Freightliner® |
|-------------------------------|------------|--------------------|
| Length | 38' 10" | 38' 10" |
| Exterior Height w/Roof A/C | 12' | 12' |
| Exterior Width | 8' 5.5" | 8' 5.5" |
| Interior Height | 7' | 7' |
| Interior Width | 8' 0.5" | 8' 0.5" |
| LP Capacity - optional (gal.) | 28 | 28 |
| Fuel Capacity (gal.) | 80 | 80 |
| Wheelbase | 248" | 248" |

Ford 26,000-lb. Gas Chassis

350-hp 7.3L V8 Triton® Engine, TorqShift™
6-speed Automatic Overdrive Transmission
w/Tow/Haul, Hydro-Max Brakes w/4-Wheel ABS

175-amp. Alternator

1.125" Solid Plywood Floor

7-pin Trailer Wiring

Trailer Hitch 5,000-lb. drawbar/500-lb.
maximum vertical tongue weight

Leveling System - HWH Automatic Controls
(front 9,000-lb./rear 12,000-lb.)

Seats - Ultrafabrics

Carpeted Storage Areas

Steel Front End Structure Designed for
Engine Removal

Valance Panels - Integrated Storage Doors

Front Overhead Storage Cabinet

Convenience Tray w/Cup Holders

Stylized Aluminum Wheels

Driver Cab Entry Door

Auxiliary Defroster Fans

Powered Front Shade

Map Lights

Power Mirrors w/Defrost

Passenger Seat Dash Workstation

Cruise Control

Fog Lamps

Radio/Rearview Monitor System

Freightliner 26,000-lb. Diesel Chassis

Cummins® ISB 6.7L 340 HP Engine @
2,600 RPM; 700 lb.-ft. @ 1,600 RPM

Allison® 2350 MH-Series 6-speed
Automatic Transmission w/Park Pawl

OPTIONAL FEATURES

Freightliner 26,000-lb. Air Brake/Air
Suspension

Freightliner 27,500-lb. Diesel Chassis

Freightliner 27,500-lb. Air Brake/Air Suspension

Slideout Rooms

Left Side

Right Side (requires left side slide room)

Fiberglass Interior Walls

Exterior Ladder

7KW - 20KW Commercial Generators

Entrance Door Window

LP Tank and 40,000 BTU Furnace

Walls: Antimicrobial Fiberglass, Decorative
Paneling, Luan

SUPERSTRUCTURE

BUILT TO LAST

Interlocking Joints

Specially engineered interlocking joints connect the floor, sidewalls and roof where competitors often rely on simple screws to bear the weight.

Laser-Cut Tubing

Precision laser cutters create precise joints in structural steel that are stronger and require less welding.

Fiberglass Roof

The crowned, one-piece fiberglass roof is backed by a 10-year limited parts-and-labor roof skin warranty.

1 1/8" Wood Flooring

Commercial grade floor for solid walking surfaces and flexibility in mounting equipment.

Thermo-Panel® Sidewalls

By layering fiberglass and high-density block foam insulation with welded aluminum support structures, we create some of the industry's strongest, most durable and lightweight sidewalls.

E-Coating

An electrodeposition coating helps protect critical steel components.

Embedded Steel

Metal substructures embedded into the sidewall provide solid attachment points to keep cabinets and appliances mounted securely in place.

Solid Framework

Aluminum extruded in our own facility to our exacting standards creates an extremely strong and solid structural framework.

Open Steel Risers

Open steel risers replace the aluminum risers. This improves strength and provides the ability to run wires and tubing more easily through the open layout.

To learn more about how Winnebago Specialty Vehicles and our partners can assist with your mobile outreach needs, please visit SV.Winnebago.com or call (800) 492-9135.

WINNEBAGO
SPECIALTY VEHICLES

©2022 Winnebago Printed in USA NYSE: WGO